

www.butkus.us



35 mm

OLYMPUS®

XA1

& Electronic Flash A9M

■ INSTRUCTIONS



This manual is for reference and historical purposes, all rights reserved.

This page is copyright© by M. Butkus, NJ.

This page may not be sold or distributed without the expressed permission of the producer

I have no connection with any camera company

On-line camera manual library

This is the full text and images from the manual. This may take 3 full minutes for the PDF file to download.

If you find this manual useful, how about a donation of \$3 to: M. Butkus, 29 Lake Ave., High Bridge, NJ 08829-1701 and send your e-mail address so I can thank you. Most other places would charge you \$7.50 for a electronic copy or \$18.00 for a hard to read Xerox copy.

This will allow me to continue to buy new manuals and pay their shipping costs.

It'll make you feel better, won't it?

**If you use Pay Pal or wish to use your credit card,
click on the secure site on my main page.**

PayPal Name Lynn@butkus.org

www.PayPal.me/lynnbutkus

1

SNAPSHOTS
Schnappschusse
INSTANTANES
Instantáneas

1.

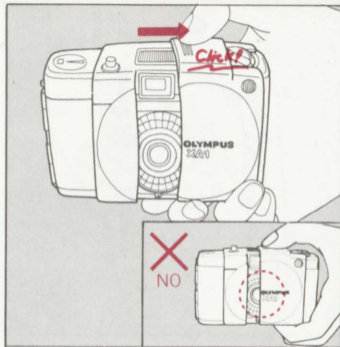

2.

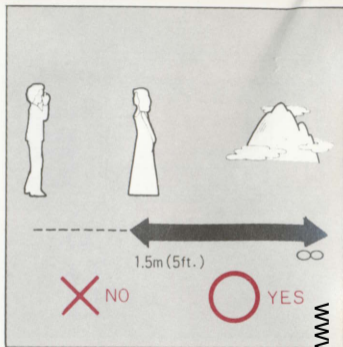

3.



4.

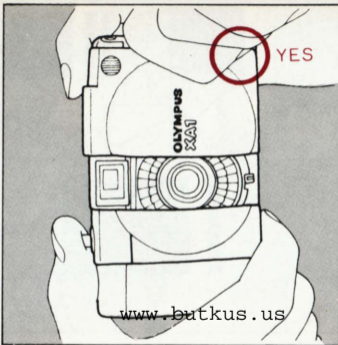

5.

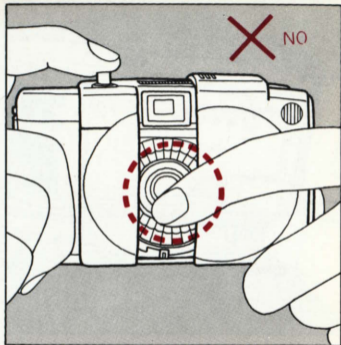

2

PREPARATION FOR FLASH
PHOTOGRAPHY
Vor Blitzaufnahmen
PREPARATION POUR
PHOTOGRAPHIE AU FLASH
Preparación para fotografía
con el flash

1.



2.

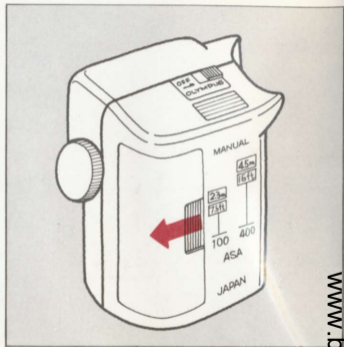

3.

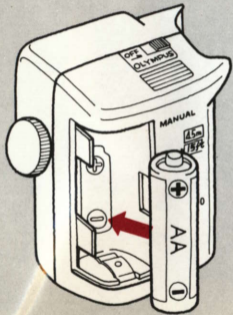

4.

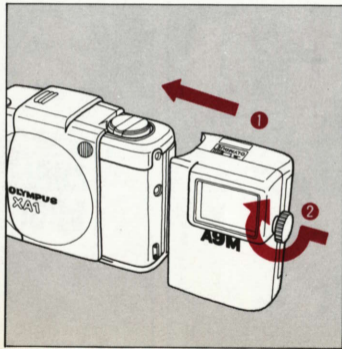

5.

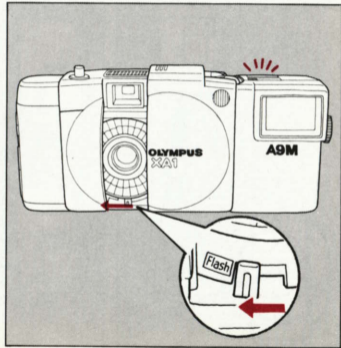

3

FLASH PHOTOGRAPHY
Blitzaufnahmen
PHOTOGRAPHIE AU FLASH
Fotografía con el flash

1.

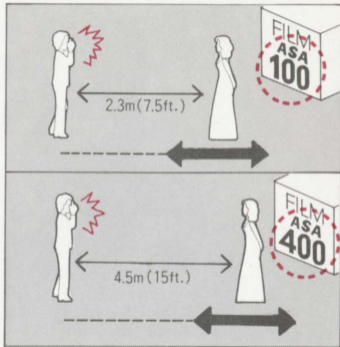

2.

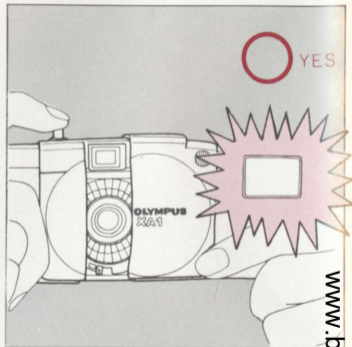

3.

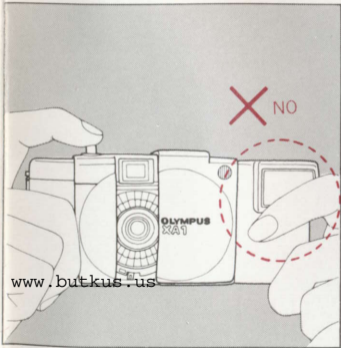

4.



5.

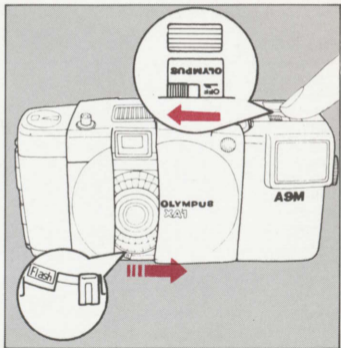

4

UNLOADING THE FILM
Herausnehmen
DECHARGEMENT DU FILM
Descarga de la película

1.

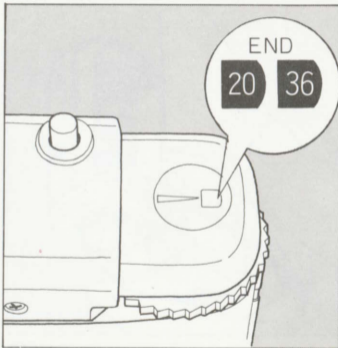

2.

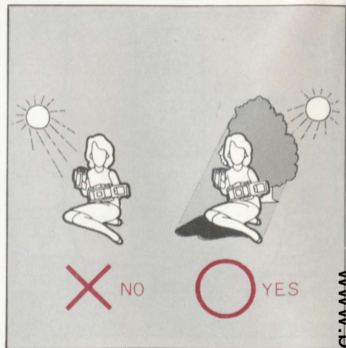

3.

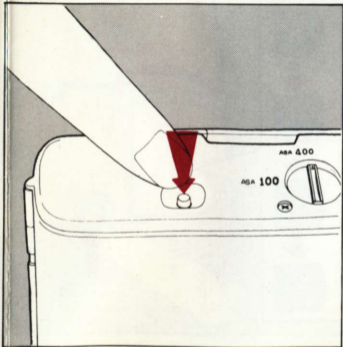

4.



5.

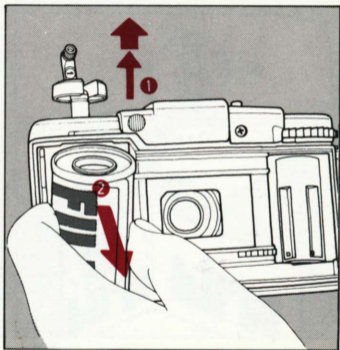

7.

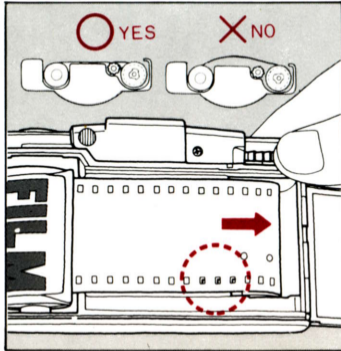

8.

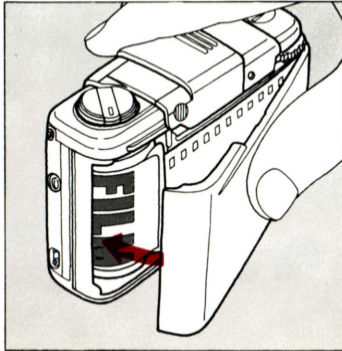

9.

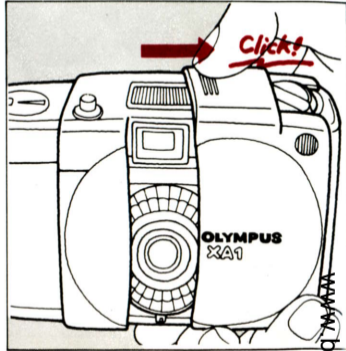

10.

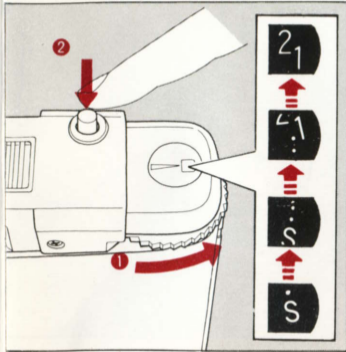

11.

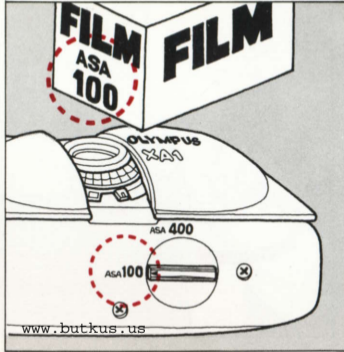

12.

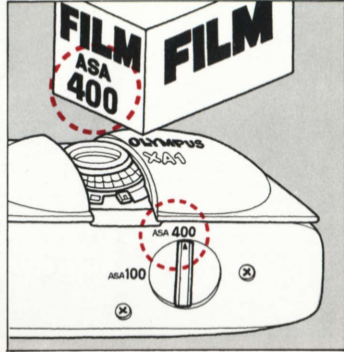

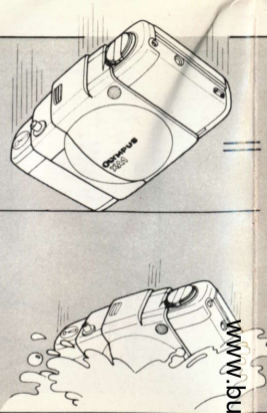
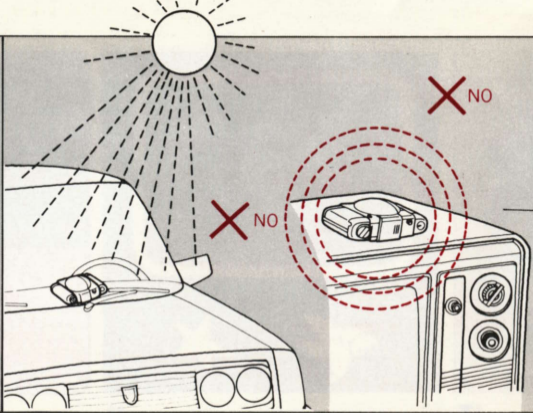
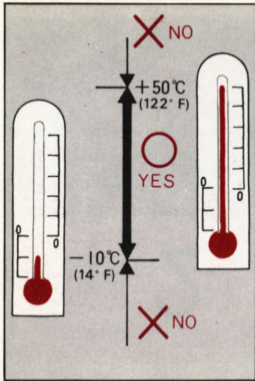

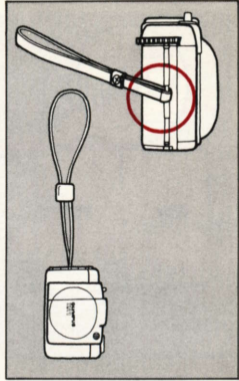
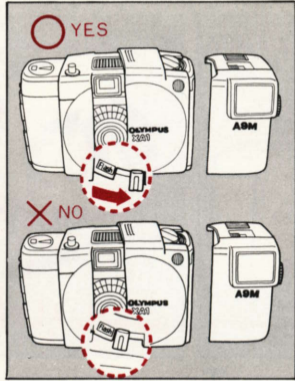
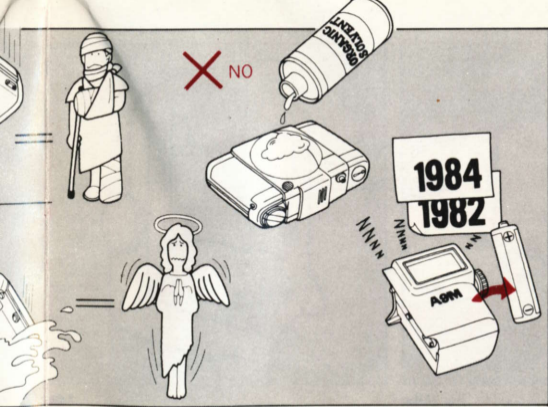

PREPARATION
Vorbereitung

PREPARATION
Preparación

1.

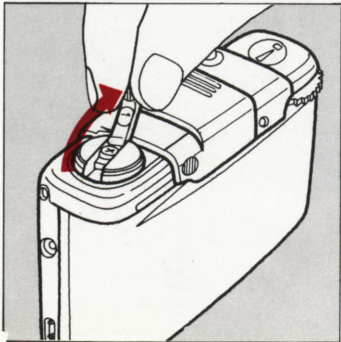

2.

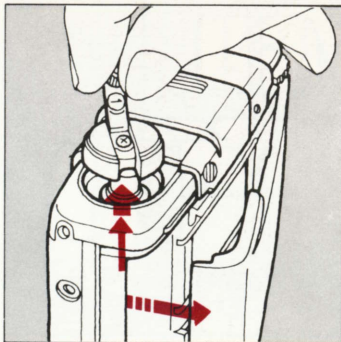

3.

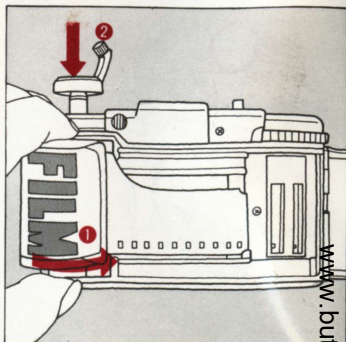

4.

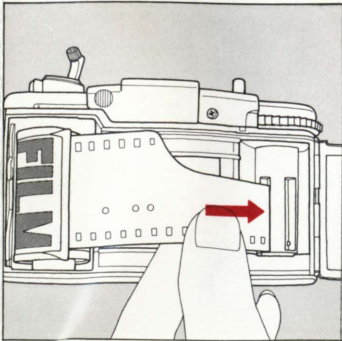

5.

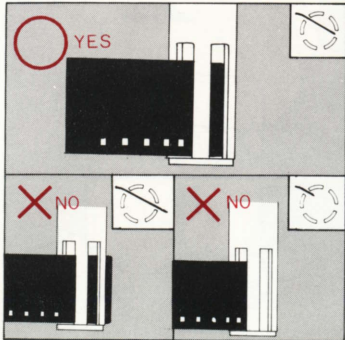

6.

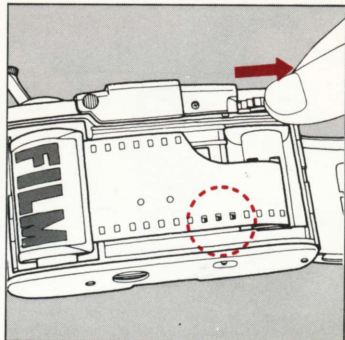

XA1

- Camera type:** 35mm lens-shutter camera.
Film format: 35mm standard cassette (24 x 36mm)
Lens: D. Zuiko 35mm F4, 4 elements in 4 groups.
Shutter: Programmed between-lens shutter (F4 · 1/30 sec. ~ F22 · 1/250 sec.)
Exposure control: Automatic by built-in selenium cell meter. Shutter release locks to prevent under-exposure.
Viewfinder: Bright frame finder, 0.5X. Red signal indicated under-exposure.
Exposure counter: Progressive type with automatic reset.
Film rewind: Crank type with rewind release button.
Focusing: Universal focus (1.5m or 5 ft. ~ ∞).
Exposure range: EV 9~17 (ASA 100).
Applicable film speeds: ASA 100 and 400.
Film advance: Rear winding thumbwheel (360°).

MAIN SPECIFICATIONS www.butkus.us

Built-in prevention against double advance and double exposure.

Flash mounting: Exclusive Electronic Flash A9M attaches to (or detaches from) the camera in seconds.

Setting camera's flash lever to 'Flash' switches flash unit on and off.

Lens/finder barrier: Sliding cover.

Power source: Solar-powered selenium photo cell.

Dimensions: 104(W) x 65(H) x 40(D) mm.
(4.1 x 2.6 x 1.6 in.)

Weight: 190 grams (6.7 oz.)

Electronic Flash A9M

Unit type: Electronic flash unit.

Guide number: 9 (ASA 100, metres).

or 30 (ASA 100, feet).

Film speeds: ASA 100 and 400.

Number of flashes: Approx. 180 with 1.5V AA 'alkaline' battery.

Recycle time: Approx. 7 sec. with 1.5V AA 'alkaline' battery.

Connection to camera: XA1 exclusive mount.

Power source: 1.5V AA 'penlight' battery x 1 (including Ni-Cd battery).

Dimensions: 60(H) x 39(W)* x 36.5(D) mm. (2.4 x 1.5* x 1.4 in.)

*Measured from interface.

Weight: 50 grams (1.8 oz.) without battery.

OLYMPUS

OLYMPUS OPTICAL CO., LTD.

San-Ei Building, 22-2, Nishi Shinjuku, 1-chome, Shinjuku-ku, Tokyo, Japan.
Tel. 03-340-2211

OLYMPUS CAMERA CORPORATION

Crossways Park, Woodbury, New York 11797, U.S.A. Tel. 516-364-3000

OLYMPUS OPTICAL CO. (EUROPA) GMBH.

Postfach 104908, Wendenstrasse 14-16, 2 Hamburg 1, West Germany.
Tel. 040-23773-0

OLYMPUS OPTICAL CO. (U.K.) LTD.

2-8 Honduras Street, London EC1Y 0TX,
England. Tel. 01-253-2772

Printed in Japan

0782. 30MB.